



Water, Sewer, and Solid Waste Committee

13 May 2025

5:30 P.M.

(Or immediately following Equipment Committee)

Committee: Council Member Teresa Turk, Council Member Mike Wiederkehr, Council Member Scott Berna, Council Member Bob Stafford

Copy to: Mayor Molly Rawn, Steve Dotson, Keith Macedo, Kara Paxton, Kit Williams, Chris Brown, Alan Pugh, Terry Gulley, Ross Jackson, Peter Nierengarten, Brian Pugh, Corey Granderson, Aaron Watkins, Cody Ashworth, Scott Murphy, Brian Rowland

From: Tim Nyander, Utilities Director

CALL TO ORDER

UPDATES

PRESENTATIONS:

1. Overview of April's WRRF Monthly Report

Scott Murphy – WRRF Project Manager, Inframark

2. Overview of April's Water & Sewer Operations

OLD BUSINESS:

3. West Transmission Waterline Updates

Utilities Engineer Corey Granderson will provide updates to the Committee on this project.

INFORMATION ONLY

NEW BUSINESS:

4. Ozone Destruction System Replacement – Noland WRRF

The City of Fayetteville utilizes ozone to eliminate potentially harmful bacteria and organic compounds from the millions of gallons of treated water produced by the Paul R Noland Wastewater Treatment facility every day. This unique treatment process ensures an unmatched level of protection for the White River Watershed.

The use of an ozone destruct unit is an essential safety measure when dealing with high concentrations of ozone. The original units have operated every hour of every day for nearly 15 years in a highly corrosive environment at the Noland Wastewater Treatment Facility. Since their installation, it has been determined that the original units are undersized to meet the current ozone destruction requirements.

Discussion on purchasing replacement units.

STAFF REQUESTS THIS BE FORWARDED TO THE CITY COUNCIL FOR CONSIDERATION FOR APPROVAL

5. Sewer Service Request – Washington County

Mr. Foster is building a home at 2484 S. Dead Horse Mountain Road. The property is in Washington county but is adjacent to the city limits and can physically access sanitary sewer. Water service is already available and approved. Staff supports approval of a sewer service tap to Mr. Foster pending council approval.

STAFF REQUESTS THIS BE FORWARDED TO THE CITY COUNCIL FOR CONSIDERATION FOR APPROVAL

6. Code Updates; Chapter 51.145

City Staff recommends code adjustments to Chapter 51.145 regarding address number requirements on new buildings. This section of code is enforced by the meter division and the code is out of date with actual practices. Clear, visible address numbers are critical for emergency services to identify correct properties in-field, including during adverse weather or nighttime conditions. Staff will present the existing and proposed language.

STAFF REQUESTS THIS BE FORWARDED TO THE CITY COUNCIL FOR CONSIDERATION FOR APPROVAL

PRESENTATIONS

April WRRF Report
April Water & sewer Operations Report

ATTACHMENTS

April WRRF Report
Quote – Oxidation Technologies, LLC
Deadhorse Mountain Sewer Service Location
Address Number Requirements Ordinance Marked Up
Address Number Requirements Clean Copy

ADJOURN

Next Water, Sewer, Solid Waste Committee meets on
Tuesday, June 9th, 2025, at 5:30 p.m.



214 W Hwy 18, PO Box 29
 Inwood, IA 51240
 (515) 635-5854

Estimate

Date	Estimate #
4/18/2025	19049

Name / Address
Inframark Michael R Muenich 1400 N Fox Hunter Rd Fayetteville, AR 72701

Ship To
Inframark Michael R Muenich 1400 N Fox Hunter Rd Fayetteville, AR 72701

Terms	Rep
Prepayment	JML

Item	Description	Qty	Cost	Total
CDU-400	<p>Ozone Destruct System - 350 CFM</p> <p>Safely revert ozone gas to oxygen at flow-rates up to 350 CFM with wet/humid gas intake Uses Carulite-200 Destruct media for ozone destruction 99.96% ozone destruction efficiency 6.2 Horsepower Regenerative Blower - HRC-1020 used for airflow through destruct system 20" diameter stainless steel shell to hold 235 lbs of Carulite-200 destruct media Heater incorporated to keep catalyst warm and prevent condensation</p> <p>480 VAC, 3-phase electrical power required Control box included on frame - Motor starter for blower - heater controls - local ON/OFF switch - remote control option included</p> <p>3" Female NPT inlet/outlet connections</p>	2	22,120.00	44,240.00
Total				\$44,240.00

To process this estimate into an order, please e-mail sales@oxidationtech.com for a link to pay with credit card. To be set up with Net 30 terms e-mail martha@oxidationtech.com with 3 credit references & W9 for approval. Feel free to call us at 515-635-5854 with any questions regarding placing an order!

Customer Signature

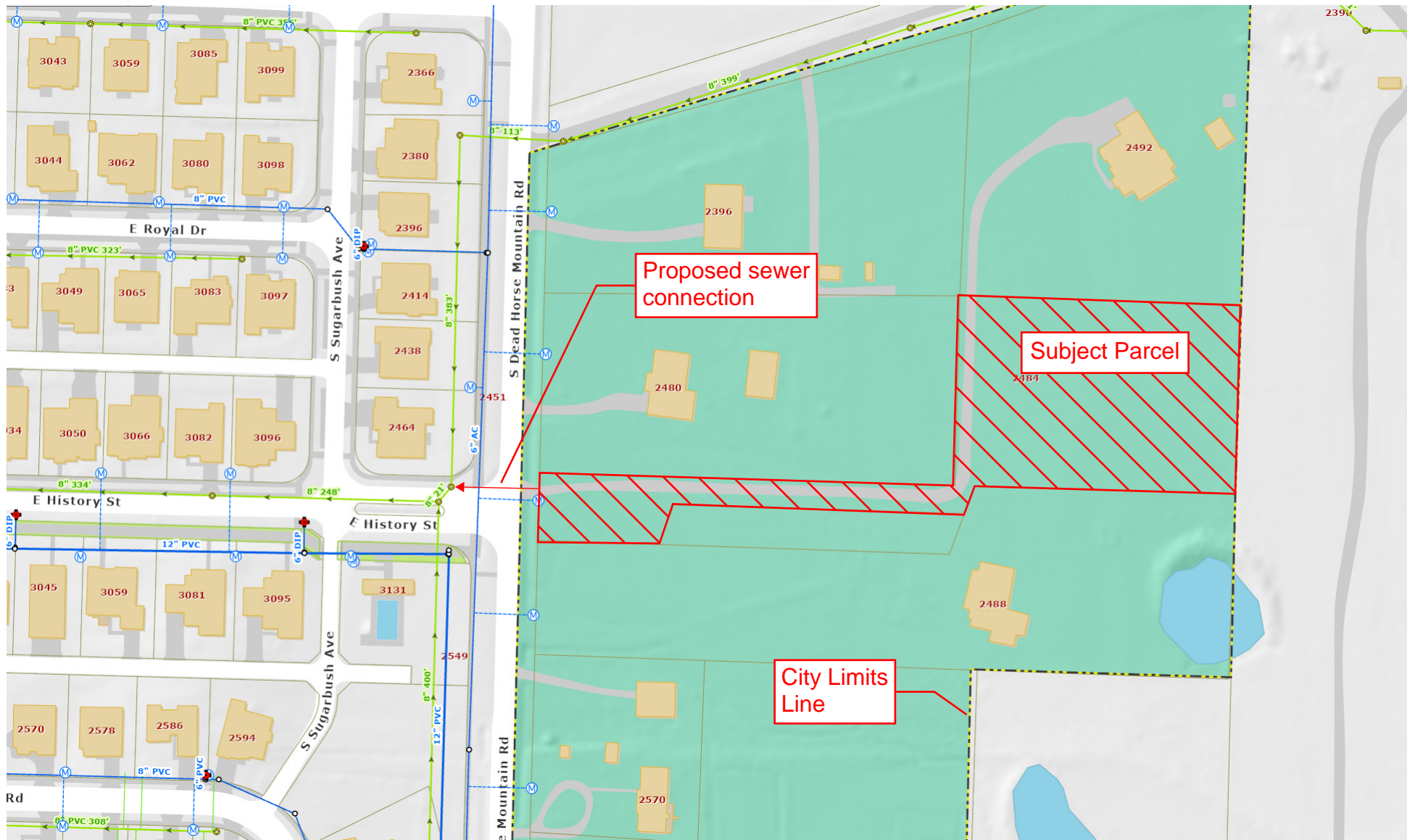

51.145 Address Number Requirements

- (A) *Definitions.* For the purpose of this section, the following definitions shall apply unless the context clearly indicates or requires a different meaning.
- (1) *Permanent Numbers.* Address numbers assigned to the building by the city that are raised numbers at least 4 inches in height, made of metal, wood, or plastic and are ~~nailed or screwed~~ affixed to the building using nails, screws, or similar fasteners. ~~These numbers are those assigned to the building by the city.~~
 - (2) *Stick-on Numbers.* Address numbers assigned to the building by the city that ~~have an adhesive backing that~~ are designed, or were originally designed, to use adhesive to stick onto a glass surface of the building.
 - (3) *Temporary Numbers.* Address numbers assigned by the city that are raised numbers, made of metal, wood, or plastic and are nailed or screwed onto a board, and staked into the ground and rise from three to four feet above the ground. Temporary numbers may also be painted onto a board and staked into the ground.
- (B) *Permanent Address Numbers Required.*
- (1) ~~All residential and non-residential properties shall have P~~ permanent numbers ~~must be nailed or screwed into the building and must be~~ that are clearly visible from the street.
 - (2) All numbers shall be installed at the expense of the owner and shall be maintained at the owner's expense.
 - ~~(3) No "stick-on" numbers shall be accepted.~~
 - ~~(4) All numbers must be made of metal, plastic, or wood.~~
 - ~~(5) All numbers must be at least 3 inches in height.~~
 - (6) All numbers must be contrasting in color to the building.
 - (7) Numbers must be displayed on the front of the building, or on the side that faces the street and easily visible from the street.
 - ~~(8) Commercial establishments must have permanent numbers nailed or screwed into the building.~~
 - ~~Commercial establishments with glass fronts may have painted numbers on the glass, but only if there is nowhere possible to nail or screw permanent numbers into the building.~~
 - (9) Commercial establishments that have individual suites must have permanent numbers on the building (building number) and also permanent numbers on each suite (suite number).
 - ~~(10) Mobile homes must have permanent address numbers nailed or screwed into the trailer/mobile home.~~ The numbers must be affixed to the side or end of the ~~trailer/mobile home~~ that faces the street.
 - ~~(11) Mobile home parks must have the park address number displayed at the entrance to the park (may have permanent numbers or painted numbers affixed to park entrance sign), and must also have permanent, individual space numbers affixed to each mobile home.~~
 - ~~(12) Apartment buildings must have the building number permanently affixed to each building, and must also have individual apartment numbers permanently affixed to each apartment.~~
- (9) Exceptions
- (a) A commercial establishment with a glass front that does not have an adequate location for a permanent number to be affixed to the building may have:

(i) Painted numbers at least 4 inches in height on the outside of the glass front; or

(ii) Stick-on numbers at least 6 inches in height affixed to the inside of the glass.

~~(13)~~(b) Buildings not visible from the street must have permanent numbers nailed or screwed into a board and posted at the entrance of the driveway (either on a post or on a tree); numbers must raise from 3 to 4 feet above the ground, and be clearly visible from the street. If two (2) or more buildings are on the same drive, permanent numbers must also be nailed or screwed into each individual building, as well as both numbers posted at the entrance of the driveway.

~~(14)~~c Construction sites, where the building is not complete enough to affix permanent address numbers, must display temporary numbers at the construction site where they are clearly visible from the street.

~~(15)~~d Locations where there is a water meter for purposes of irrigating, watering stock, chicken houses, and the like where there is no building to affix numbers, must be permanently nailed or screwed onto a board and posted at the entrance of the driveway; numbers must rise from three to four feet above the ground, and be clearly visible from the street. If there is no driveway to the property, the board must be posted near the water meter box.

Any variations from this policy must have the prior written consent of the water and sewer services superintendent.

Commented [BP1]: Is this still a position or do we need to refer to a different position?

(C) *Service Requests.*

- (1) Permanent numbers must be displayed before any service calls will be made by the city.
- (2) Permanent numbers must be displayed before a meter check or billing adjustment is made by the Water and Sewer Division.
- (3) Permanent numbers must be displayed before water service is turned on at the address.
- (4) In the event a service call is made and the address number is not displayed in the above manner, the property owner shall be assessed a fee of \$15.00 for each trip to the property made by a service person provided there shall be no charge for the first two (2) trips. There shall be a \$25.00 fee assessed for any service calls made after normal working hours (weekdays between 4:00 p.m. and 8:00 a.m., on holidays, or on weekends).
- (5) For existing water services which do not have permanent numbers prominently displayed, the consumer shall be given written notice by certified mail that if his permanent numbers are not prominently displayed within twenty-one (21) days from the date of the notice, water service shall be disconnected and shall not be reconnected until permanent numbers have been properly displayed and a \$15.00 service charge is paid.

(Ord. No. 3569, 10-1-91; Code 1991, §51.145)

51.145 Address Number Requirements

- (A) *Definitions.* For the purpose of this section, the following definitions shall apply unless the context clearly indicates or requires a different meaning.
- (1) *Permanent Numbers.* Address numbers assigned to the building by the city that are raised numbers at least 4 inches in height, made of metal, wood, or plastic and are affixed to the building using nails, screws, or similar fasteners.
 - (2) *Stick-on Numbers.* Address numbers assigned to the building by the city that are designed, or were originally designed, to use adhesive to stick onto a glass surface of the building.
 - (3) *Temporary Numbers.* Address numbers assigned by the city that are raised numbers, made of metal, wood, or plastic and are nailed or screwed onto a board, and staked into the ground and rise from three to four feet above the ground. Temporary numbers may also be painted onto a board and staked into the ground.
- (B) *Permanent Address Numbers Required.*
- (1) All residential and non-residential properties shall have permanent numbers that are clearly visible from the street.
 - (2) All numbers shall be installed at the expense of the owner and shall be maintained at the owner's expense.
 - (3) All numbers must be contrasting in color to the building.
 - (4) Numbers must be displayed on the front of the building, or on the side that faces the street and easily visible from the street.
 - (5) Commercial establishments that have individual suites must have permanent numbers on the building (building number) and also permanent numbers on each suite (suite number).
 - (6) Mobile homes must have permanent address numbers nailed or screwed into the mobile home. The numbers must be affixed to the side or end of the mobile home that faces the street.
 - (7) Mobile home parks must have the park address number displayed at the entrance to the park (may have permanent numbers or painted numbers affixed to park entrance sign), and must also have permanent, individual space numbers affixed to each mobile home.
 - (8) Apartment buildings must have the building number permanently affixed to each building, and must also have individual apartment numbers permanently affixed to each apartment.
- (9) *Exceptions*
- (a) A commercial establishment with a glass front that does not have an adequate location for a permanent number to be affixed to the building may have:
 - (i) Painted numbers at least 4 inches in height on the outside of the glass front; or
 - (ii) Stick-on numbers at least 6 inches in height affixed to the inside of the glass.
 - (b) Buildings not visible from the street must have permanent numbers nailed or screwed into a board and posted at the entrance of the driveway (either on a post or on a tree); numbers must raise from 3 to 4 feet above the ground, and be clearly visible from the street. If two (2) or more buildings are on the same drive, permanent numbers must also be nailed or screwed into each individual building, as well as both numbers posted at the entrance of the driveway.

(c) Construction sites, where the building is not complete enough to affix permanent address numbers, must display temporary numbers at the construction site where they are clearly visible from the street.

(d) Locations where there is a water meter for purposes of irrigating, watering stock, chicken houses, and the like where there is no building to affix numbers, must be permanently nailed or screwed onto a board and posted at the entrance of the driveway; numbers must rise from three to four feet above the ground, and be clearly visible from the street. If there is no driveway to the property, the board must be posted near the water meter box.

Any variations from this policy must have the prior written consent of the Utilities Director

(C) *Service Requests.*

- (1) Permanent numbers must be displayed before any service calls will be made by the city.
- (2) Permanent numbers must be displayed before a meter check or billing adjustment is made by the Water and Sewer Division.
- (3) Permanent numbers must be displayed before water service is turned on at the address.
- (4) In the event a service call is made and the address number is not displayed in the above manner, the property owner shall be assessed a fee of \$15.00 for each trip to the property made by a service person provided there shall be no charge for the first two (2) trips. There shall be a \$25.00 fee assessed for any service calls made after normal working hours (weekdays between 4:00 p.m. and 8:00 a.m., on holidays, or on weekends).
- (5) For existing water services which do not have permanent numbers prominently displayed, the consumer shall be given written notice by certified mail that if his permanent numbers are not prominently displayed within twenty-one (21) days from the date of the notice, water service shall be disconnected and shall not be reconnected until permanent numbers have been properly displayed and a \$15.00 service charge is paid.

(Ord. No. 3569, 10-1-91; Code 1991, §51.145)